

THERMAL MONOPANL® WALL SYSTEM

A complete factory fabricated wall panel

- Full 12' covering width
- Double tongue and groove self sealing system provides snug vertical joints
- Stucco Embossed finish on the exterior and interior face
- Factory applied Butler-Cote® finish system
- No exposed exterior fasteners
- Full line of accessories available

Features

Thermal Monopanl wall system is unique in that it provides both finished interior and exterior metal faces. The exterior, with its 6" box ribs, creates a pleasing vertical line and forms accent shadows that are everchanging with the sun's movement. Monopanl panels may be used to provide the entire wall or used in conjunction with other Butler wall systems or masonry.

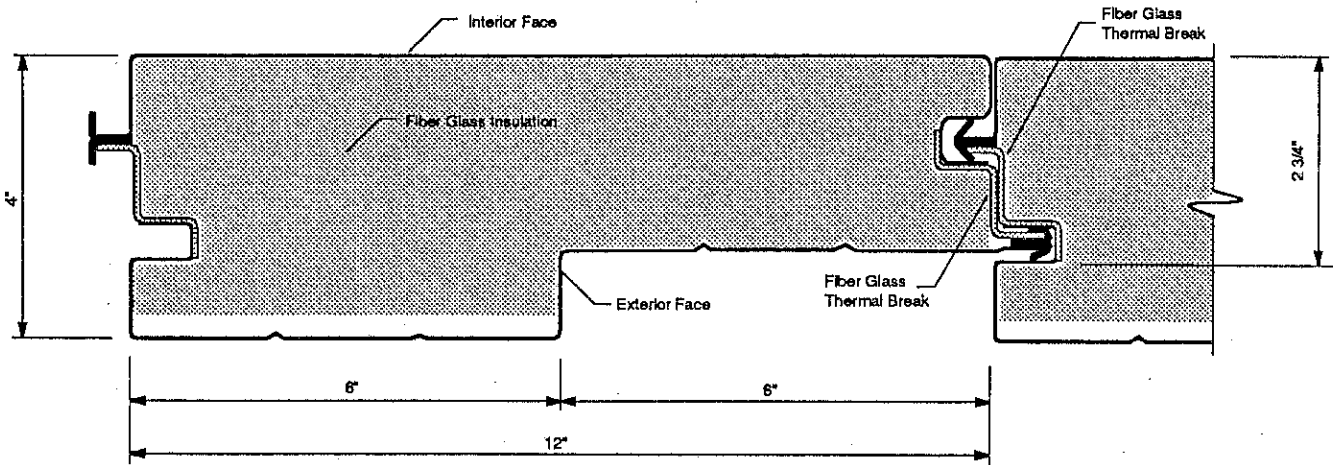

4" THERMAL MONOPANL PANEL CROSS SECTION

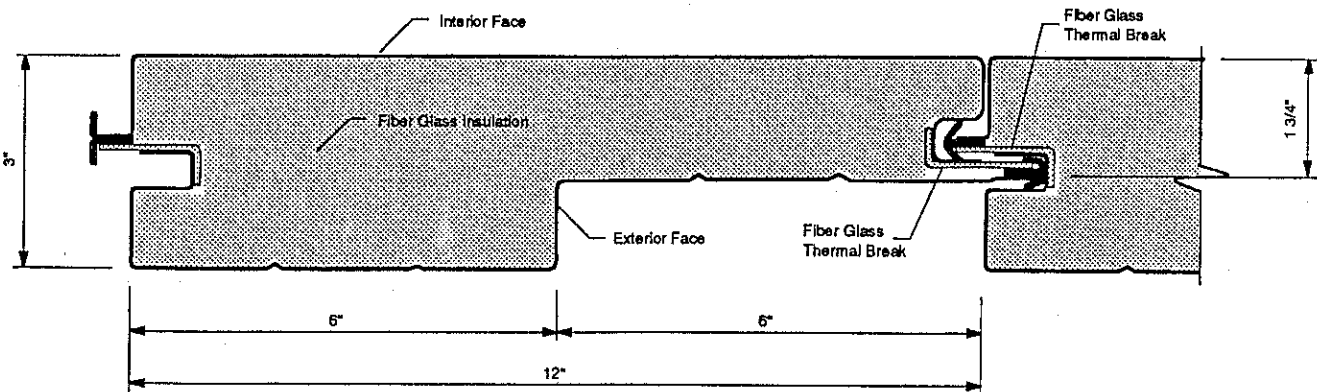

3" THERMAL MONOPANL PANEL CROSS SECTION



PRODUCT DESCRIPTION

3' & 4" THERMAL
MONOPANL®

Butler Building Products are constantly being improved; therefore, the information contained herein is subject to change without notice. Before finalizing project details, contact your nearest Butler Builder® or Butler Manufacturing Company for the latest information.

Form No. 2401 LW 04-92